

4721007 Lid

4721005 Jug

4721010 3 ft. Vacuum Hose (sold as each)

4721006 Universal Inflation Adapter

4721009 3 ft. Silicone Hose (sold as each)

# Quarter Milkers

## Coburn EasyPour QuarterMilker

### Features:

- 2.5 gallon capacity
- One handed pouring
- Heavy-duty polyethylene construction
- Low-profile design
- Large opening for easy cleaning

Comes complete with lid, 3 ft. silicone hose, 3 ft. vacuum hose, and universal inflation adapter.

**4721000** EasyPour Quarter Milker complete, instructions included. Boxed with 4-color label. Wt. 5.25 lbs.



## Quarter Milker

### Features:

- 2 gallon capacity
- Built-in safety valve
- Tip-proof design

**97QMA** Quarter Milker, complete. Wt. 4 lbs.

**97QMK** Service Kit. Includes all parts except jug and handle.

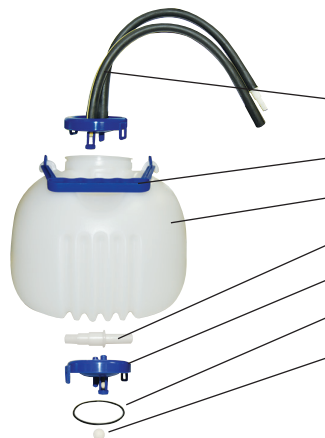

**97QMK** Service Kit contains all parts except container and handle.

**97QMR** Rubber Hose 3/8" X 20" (sold as each, two are required)

**97QMH** Plastic handle

**97QMB** Hi-capacity container

**97QMC** Multi-fit connector

**97QML** Lid with safety valve

**97QMO** O-ring for lid

**97QMV** Ball & cap for safety valve



## Large Capacity Quarter Milker

### Features:

- 2.5 gallon capacity
- Heavy-duty polyethylene construction
- Multi-purpose lid, can also be used on fresh cow buckets

**100QMA** Large Capacity Quarter Milker including bucket, lid, gasket, tubes and inflation adapter. Wt. 7.6 lbs.



**100QMH** Handle w/ Nuts

**100QMLG** Lid with gasket

**3000017** Gasket only

**97QMC** Connector

**126R** Hose (order 2 ft.)

### Features:

- 2 gallon capacity
- Locking lid
- Silicone tubing

**10-35000** 2 Gallon QMI Quarter Milker complete. Wt. 5.4 lbs.

**10-35010** Bowl for QMI

**10-35011** Lid for QMI

**10-35300** Gasket for QMI

**10-35510** Silicone Tubing to Inflation for QMI, 24"

**10-35520** Silicone Tubing to Claw for QMI, 26"

**10-35600** SS 90-Degree Connector Elbow for QMI



## QMI™ Quarter Milker



The Coburn Company, Inc. • P O Box 147 • Whitewater, WI 53190 U.S.A.

800 776 7042

262 473 2822

coburn.com

info@coburn.com



# Milk Testing Accessories



## In-Line Milk Sampler



The Ambic Milk Sampler is a stand-alone representative milk sampling device which is inserted into the milk hose of each milker. The design of the Sampler allows collecting across the entire milking so that a representative sample is obtained. The collection bottle slips off easily and has an attached cap for convenience and protection of the sample. The sampler body also has an attached cap for closing it off. Once installed with the mounting bracket, the sampler body stays in place for clean-in-place (CIP) cleaning. Insertion into the milk line is a simple cut-and-fit procedure and the device is virtually maintenance-free.

Milk Sampler can be used with a wide variety of diagnostic and recording applications. Made of high quality chemical-resistant materials, Milk Sampler is designed to be cleaned in place. Sampler comes complete as shown with Body, 200ml Collection Bottle, Adapter, Caps, O-rings, L-shaped mounting bracket, blue plastic mounting block, cable tie and instructions. Milk Sampler works well with both low-line and high-line parlors. For 3/4" milk line.

- AMS200** Milk Sampler complete.
- AMS202** Replacement Bottle (200ml)
- AMS206** Replacement Bottle Adapter
- AMS204** Replacement Body
- AMS008** Replacement O-Rings, package of 6.



AMS202



AMS206



AMS204



AMS008



AV2001



## Mastitis Detectors



AMD005

The Vision In-Line Mastitis Detector has been designed for high-volume large-bore dairies and where a 100% reliable means of detecting clinical mastitis is required. When mastitis is present, visible clots are deposited on the screen. Improved bypass on the Vision assures minimal milk or air flow restrictions. Made of high quality food-grade materials, the Vision fits 5/8"ID or 9/16"ID tubing and features a rounded, ergonomically designed handle and smooth fit for ease of use.

- AV2001** Ambic Vision Mastitis Detector, boxed.
- AV2003** Repl. Body.
- AV2002** Repl. Screen & Holder. Pkg. of 2.
- AV2004** Repl. O-Rings. Pkg. of 6.

Original AMD005 Ambic Mastitis Detector is made of smooth, food-grade plastic, the detector snaps apart for cleaning. The Detector is inserted in the milk hose (1/2"ID or 9/16"ID) between claw and milk line. Clinical mastitis is indicated by the visible deposit of clots on the stainless steel back screen.

- AMD005** Mastitis Detector.
- AMD003** Repl. O-Ring. Pkg. of 6.
- AMD002** Repl. Screen & Holder.
- AMD006** Repl. Body.



## Mastitis Detectors

The Draminski Mastitis Detector is an accurate and easy-to-use instrument which detects sub-clinical mastitis in its earliest stages by sampling and measuring the conductivity of milk. Results are displayed on the readout of the convenient hand-held device. Complete instructions included. Model MD-1 shows one result at a time. MD-4 has enhanced software to save the results from each of the four quarters and display them on one screen simultaneously. Complete instructions included.

- MD-1** Electronic Mastitis Detector for One Quarter
- MD-4** Electronic Mastitis Detector for Four Quarters



MD-4

MD-1



The Coburn Company, Inc. • P O Box 147 • Whitewater, WI 53190 U.S.A.

800 776 7042

262 473 2822

coburn.com

info@coburn.com